

HUNTERS[®]

HERE TO GET *you* THERE



245 Rotherhithe Street

London, SE16 5FT

£2,250 Per Calendar Month



Positioned on the highly regarded Rotherhithe Street, SE16, this attractive riverside development offers a superb blend of comfort, style, and convenience. Measuring approximately 773 sq. ft., the apartment features a bright and spacious dual-aspect reception room, the perfect social hub for relaxing or hosting, complete with captivating views towards the City and Canary Wharf. Further benefiting from a secure underground parking space.

There are two generous double bedrooms, providing excellent versatility for sharers, couples, or anyone needing a dedicated workspace. The layout is complemented by two modern bathrooms, adding privacy and day-to-day practicality. Built in 1996, the property offers contemporary, low-maintenance living ideal for those seeking quality and peace of mind.

Set within an area rich in maritime heritage, residents can enjoy the sought-after riverside lifestyle, with nearby green spaces, local amenities, eateries, and well-connected transport options providing quick access across London.



Area Map



Floor Plans

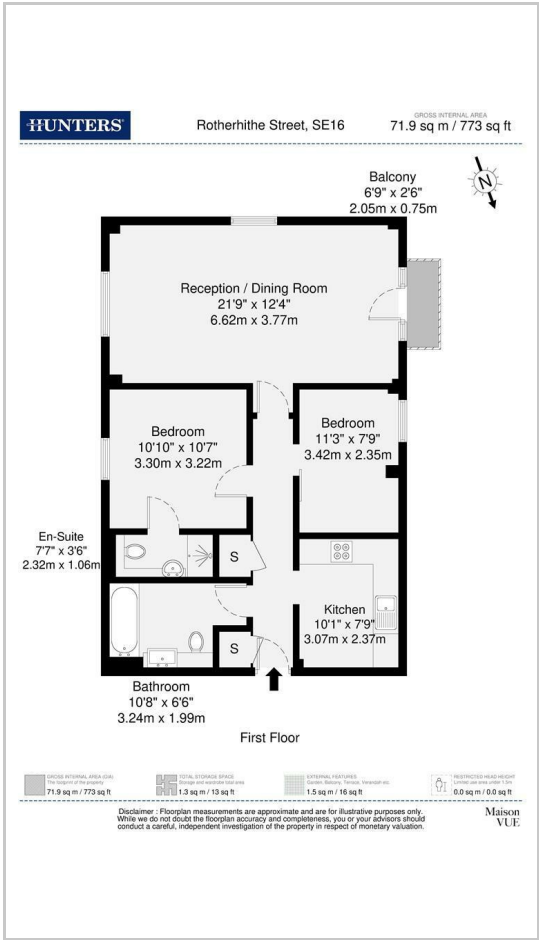

Energy Efficiency Graph

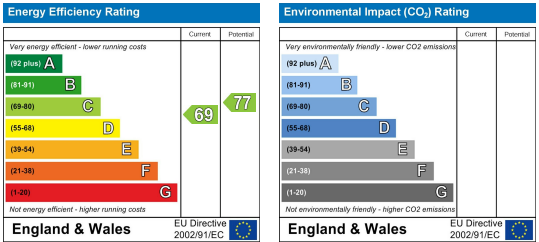

These particulars are intended to give a fair and reliable description of the property but no responsibility for any inaccuracy or error can be accepted and do not constitute an offer or contract. We have not tested any services or appliances (including central heating if fitted) referred to in these particulars and the purchasers are advised to satisfy themselves as to the working order and condition. If a property is unoccupied at any time there may be reconnection charges for any switched off/disconnected or drained services or appliances - All measurements are approximate.

THINKING OF SELLING? If you are thinking of selling your home or just curious to discover the value of your property, Hunters would be pleased to provide free, no obligation sales and marketing advice. Even if your home is outside the area covered by our local offices we can arrange a Market Appraisal through our national network of Hunters estate agents.